

# OWNER'S MANUAL

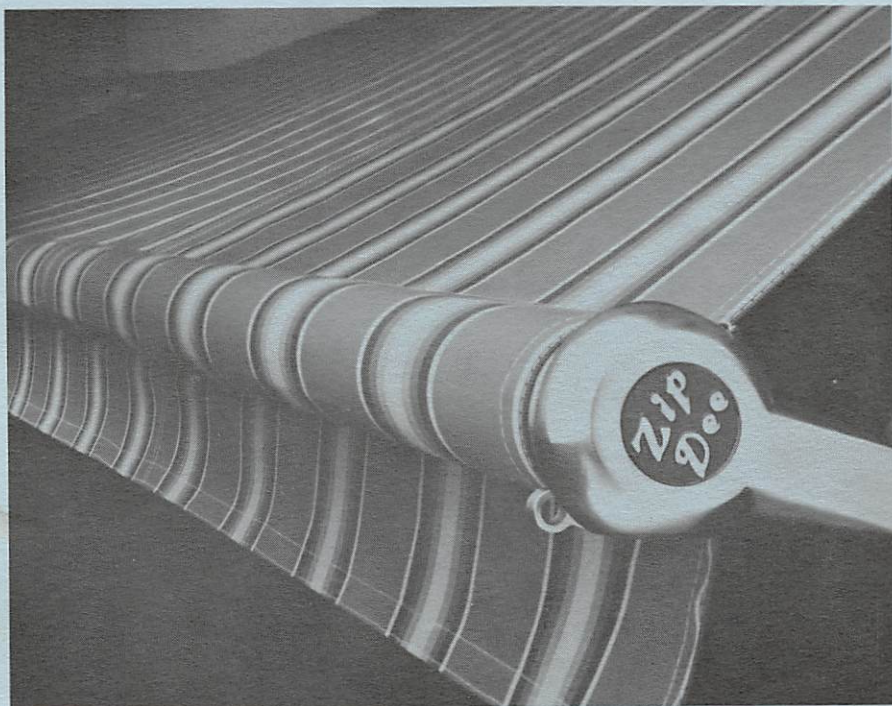

**ZIP DEE, Inc.**  
**96 Crossen Avenue**  
**Elk Grove Village, Illinois**  
**60007-1662**

**(708) 437-0980**  
**1-800-338-BEST**



***Important!***

***This is your  
official warranty.***

***It must be filled  
out & returned to  
validate warranty.***

HARDWARE SERIAL NO. 112615

HARDWARE CODE NO. 006



RV Awnings and Accessories  
Don't settle for anything less.

Providing the highest quality for over 20 years . . .

Congratulations on selecting the finest awning available for your vehicle! You can be proud of your awning because it is the end result of over 20 years of uncompromising quality and workmanship . . . an investment that will give you years of enjoyment.

Because we believe in offering our customers only the finest products, many original Zip Dee owners have become friends over the years. We hope that twenty years from now, you will still be a proud Zip Dee owner, and that we have also earned your friendship.

To get the fullest enjoyment from your Zip Dee awning, please read these few pages of hints and instructions. You'll learn how to operate your awning with ease, and how to keep it looking great for many, many years. You have the best and you want to keep it looking and operating that way.

Happy travelling . . . now that you've put a Zip Dee in your life.

Sincerely,

Robert H. Miller  
General Manager

## **FABRIC CARE...**

The beautiful fabric of your Zip Dee awning is made of acrylic fibers which cannot rot or mildew. Your awning can be rolled up wet if necessary, but be sure to open it up to dry as soon as possible.

The acrylic fabric of your awning is a synthetic and cannot support mildew or other plant growth. However, mildew can find a home on any pollen, grain dust, plant spores, or other airborne plant material that can accumulate on the awning. If mildew forms on any of these elements, it can leave a stain which can be unsightly and difficult to remove, even though it will not weaken the fabric itself. To minimize the chance of a stain, keep your awning as clean and dry as possible by hosing it down frequently between seasonal washings.

Any fabric can be punctured or torn by sharp edges that scrape or rub against it. In installations where this contact occurs, be sure to install the Zip Dee door roller at the top outer corner of the door to prevent awning damage. The rollers are inexpensive and will not be noticed on the door.

## **WASHING...**

On a monthly basis, loosen hardened dirt and dust with a dry, medium bristle brush, then thoroughly rinse both top and bottom with a hose. For more stubborn stains, use a mild solution of 1/2 cup Chlorox bleach and 1/2 cup of Ivory Flakes diluted in one gallon of lukewarm water.

Wash both sides of the awning with the solution while scrubbing with a soft brush. Saturate the fabric and leave the solution on for 15-20 minutes. (Keep the fabric saturated by reapplying solution as needed.) Rinse thoroughly. Repeat if necessary until most of the stains disappear.

**CAUTION:** Never use a strong detergent or stain remover such as 409 or Fantastic on your awning. These can destroy the water repellency of the fabric.

## **WATER LEAKS...**

If leaking occurs after washing, it is usually the result of insufficient rinsing. If water drips through the needle holes in the stitching, you can use a commercial seam sealer available in canvas and trailer supply stores. You may also apply paraffin wax to the top of the seams. However, as the awning "weathers," these holes will normally seal themselves.

It is normal for slight leakage to occur through the fabric where water is allowed to accumulate or "pocket" on the fabric. See "Storm Precautions" for information on awning settings for proper water drainage. Sometimes soap or chemical residue, such as from active agents in insect fogs or sprays, can "wet" the fabric so that it appears unable to repel water. Rinse the fabric thoroughly and test for water repellency after it dries. If leakage continues, repeat the washing and thoroughly rinse.

## **STORM PRECAUTIONS...**

Because there is no warranty for damage caused by acts of God, steps should be taken to prevent damage from occurring due to wind, rain or storm.

If you are leaving or retiring for the night, close the awning. This takes only a few seconds (less time than closing your windows) and gives you the best protection. If for some reason you can't close the awning, lower both ends of it as far as you can without removing the rafter arms. This will create a sufficient slope for water run-off. If you are remaining with the awning, you may lower one end only sufficiently to divert water.

Water weighs nine pounds per gallon and your awning was not made to hold the 500 to 700 pounds that could accumulate. Since it only takes a few minutes to be completely safe, don't subject your awning and your coach to needless strain.

## **HARDWARE AND MECHANISM MAINTENANCE...**

Although your Zip Dee awning requires less maintenance than any other awning, a little care (about the same amount that you give to your coach) will keep the metal parts in top shape. The rafter arm assemblies, main arm tubes, and the awning case are bright-anodized aluminum; the castings are polished, high-strength aluminum alloys. To keep these parts new looking they should be cleaned once a year with a good quality non-abrasive chrome or aluminum polish.

The main arm bar and all fasteners and stress bearing shafts are stainless steel. These need only be cleaned occasionally to remove accumulated grime that might hinder their operation.

**At the end of each season:**

- . Tighten any loose bolts or screws (Replace missing parts only with factory authorized replacements).
- . Clean accessible hardware with non-abrasive cleaner.
- . Use a silicone lubricant only on the 1/2" round shafts that protrude from each end of the roller.
- . Extend all telescoping arms as far as possible to wipe off accumulated sand and dirt that can clog and scratch the protective aluminum finish. No lubrication is required on those parts.

## **REPLACEMENT PARTS...**

Use only genuine Zip Dee replacements parts when repairs are needed. Use of substitutes may damage your awning or void your warranty. Parts may be ordered through your local Zip Dee dealer. If you need help, we are as close as your telephone or post office. Use the number and description found on the parts list in this booklet when ordering parts and be sure to include the make, model and year of your vehicle. Warranty claims must include the damaged part. If you cannot remove the damaged parts without a replacement, you must purchase the part at full price and receive a refund (if the warranty\* applies) when we get the damaged part back. Take a moment to copy your hardware serial number and hardware code number from your front main arm tube into the cover of this manual.

All parts are sent COD unless your charge card number or check accompanies your order.

*\* Your warranty has limitations, so please read it carefully. Since warranty claims are honored only for registered original owners, mail your registration card today.*

**...ENJOY YOUR ZIP DEE**

## CUSTOM CONTOUR AWNING OPERATION

### TO OPEN THE AWNING

- Step 1. Insert the pull rod into the Z-lock lever and pull downward. (Figure 1A) This releases the awning. Then turn the clamp wheel counterclockwise and swing the assembly toward the center to free the hardware. (Figure 1B)
- Step 2. Insert the pull rod into the loop of the center control strap and unroll the awning by pulling it toward you (Figure 2). Step under the awning and fold or roll the control strap toward the backside of the roller and tuck under restraining strap.
- Step 3. **APPLICABLE ONLY TO AVION AND GMC VEHICLES (OTHERS GO DIRECTLY TO STEP 4)** Release the snap stud on the main arm (Figure 3) and raise the awning until the second height hole is engaged.
- Step 4. Release the rafter arm by pulling outward on the cap of the ratchet stud located on the upper portion of the arm. (Figure 4) Extend the arm and place the claw over the shaft of the roller.
- Step 5. Lock the rafter arm in position by pressing down on the steel main arm bar (Figure 5) until the ratchet stud clicks. At this point the fabric will be taut.
- Step 6. Raise the awning to the desired height by releasing the snap stud on the main arm and pushing up and outward on the roller assembly (Figure 6).  
Repeat steps 3-6 for the other end of the awning.

### PARTIAL EXTENSION OR "CARAVAN" POSITION

- Step 1. Follow step 1 and 2 above.
- Step 2. Insert the pull rod in the loop of the center control strap and unroll the awning to the desired extension (Figure 7). Flip the Z-lock lever into the "closed" position to hold awning extended (Figure 1A).
- Step 3. To prevent billowing, hook the claw of the unextended rafter arm over the roller shaft (Figure 4). This will require that the awning to be extended approximately four and one half feet.
- Step 4. Raise the awning to the desired height by following step 6 above.

### TO CLOSE THE AWNING

- Step 1. Release the snap stud of the main arm and lower the awning.
- Step 2. Release the ratchet stud on the rafter arm by pulling outward on the cap. Lift the claw from the roller shaft and place it on the height adjustment stud located on the inside of the main arm (Figure 16) page 10. This allows a "scissors-like" action that helps guide the arm upward.
- Step 3. Repeat steps 1 and 2 on the other end of the awning.
- Step 4. Face the awning and hold the end of the control strap firmly in one hand then push the roller up briskly with a rolling motion until you feel the spring take over. Control the speed by holding the control strap until all but 6 inches of the fabric has been rolled up. Release the strap and let the awning roll freely the rest of the way. This additional force will help tighten the fabric around the roller for the tightest, ~~most~~ appearance.
- Step 5. Lock the awning in place by reversing steps 1 and 2 of the opening procedure Figures 1A & 1B).

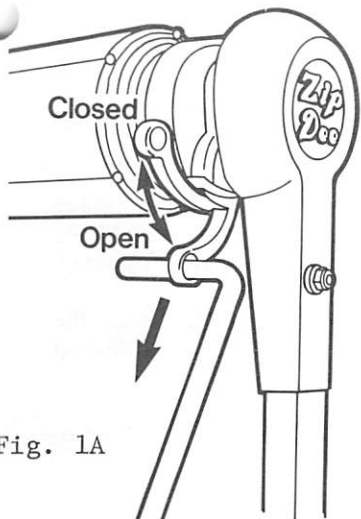

Fig. 1A

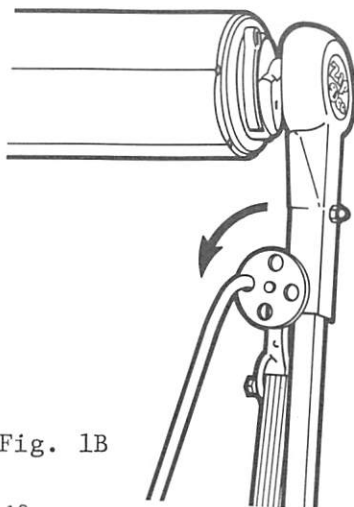

Fig. 1B

1B

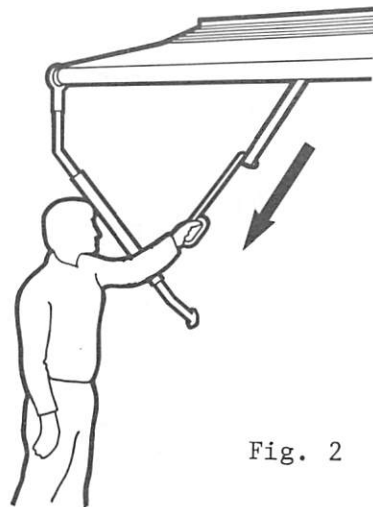

Fig. 2

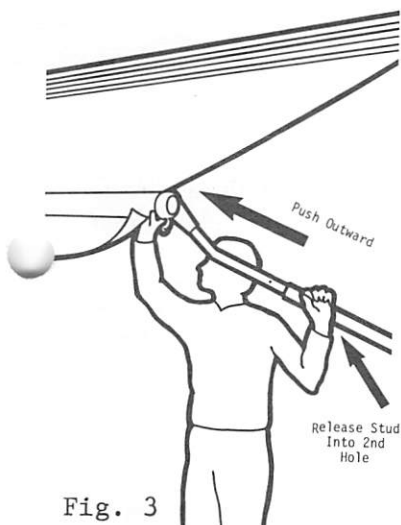

Fig. 3

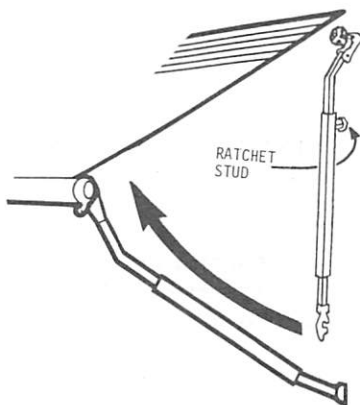

Fig. 4

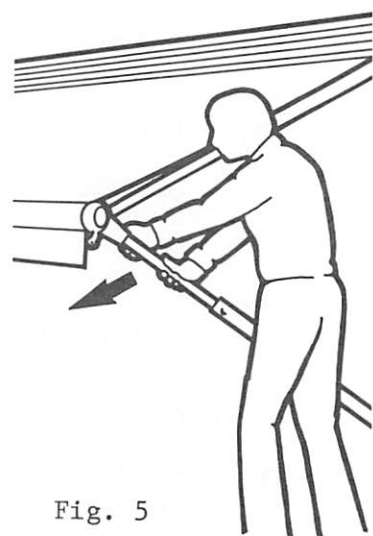

Fig. 5

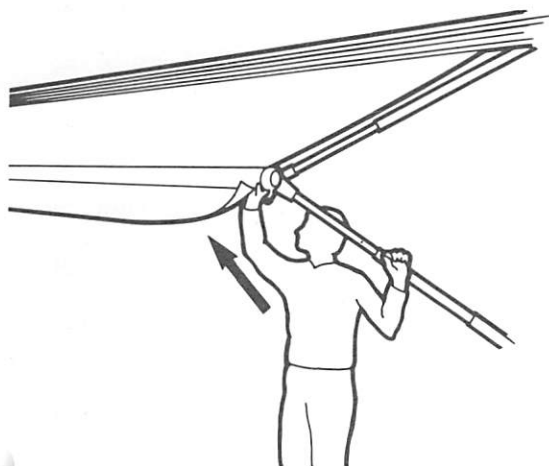

Fig. 6

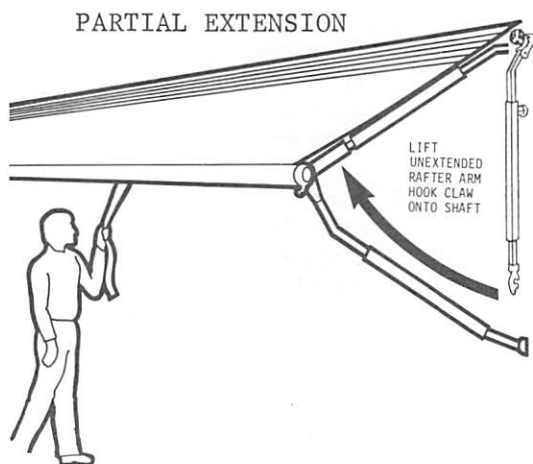

Fig. 7

## **UNIVERSAL AWNINGS OPERATION**

### **TO OPEN THE AWNING**

- Step 1. Insert the pull rod into the Z-lock lever and pull down (Figure 8). This releases the awning.
- Step 2. Insert the pull rod into the loop of the center control strap and unroll the awning by pulling it toward you (Figure 9). Step under the awning and roll or fold the control strap toward the backside of the roller and tuck under the restraining strap.
- Step 3. Release the rafter arm by pulling outward on the cap of the ratchet stud. Raise the arm upward toward the case (Figure 10). Extend the arm and set the claw shaped end into the slot of the rafter lock (Figure 11).
- Step 4. Lock the rafter arm in position by pressing down on the steel main arm bar (Figure 12) until the ratchet stud clicks. At this point the fabric will be taut.
- Step 5. Raise the awning to the desired height by releasing the snap stud on the main arm and pushing up and out on the roller assembly (Figure 13).
- Step 6. Repeat 3-5 for the other end of the awning.

### **PARTIAL EXTENSION OR "CARAVAN" POSITION**

- Step 1. Follow step 1 above.
- Step 2. Insert the pull rod in the loop of the center control strap and unroll the awning to the desired extension. Lock the awning in its position by flipping the Z-Lock lever into the "closed" position.
- Step 3. To prevent billowing, release and raise the rafter arm (Figure 10) and hook the claw of the arm into the slot of the rafter lock (Figure 14). This will require the awning to be extended approximately four and one half feet.
- Step 4. Raise the awning to the desired height by following step 5 above.

### **TO CLOSE THE AWNING**

- Step 1. Release the snap stud of the main arm and lower the awning to its bottom most position.
- Step 2. Release the ratchet stud of the rafter arm and lift the claw out of the rafter lock.
- Step 3. Place the claw casting on the protruding height adjustment stud as shown in the insert of figure 17 (page 11). To lock the assembly in a travel position, push the other tube downward until the ratchet stud snaps closed. Repeat steps 1-3 for the other end of the awning.
- Step 4. Face the awning and hold the end of the control strap firmly in one hand. Push the roller briskly upward with a rolling motion until you feel the spring take over. Control the speed of closure by holding the control strap until all but 6 inches of the fabric has rolled up. Release the strap and let the awning roll freely the rest of the way. This extra force will help tighten the fabric around the roller to insure the tightest, neatest appearance.
- Step 5. Lock the awning in place by flipping the Z-lock lever into the "closed" position using the pull rod.



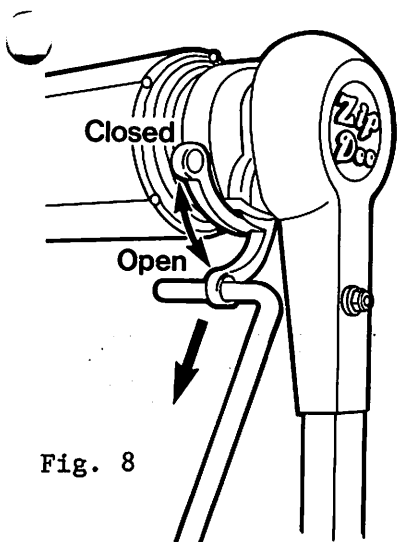

Fig. 8

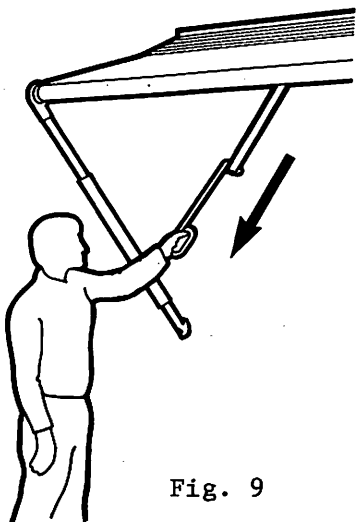

Fig. 9

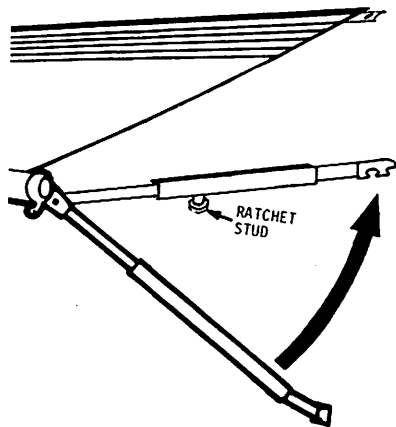

Fig. 10

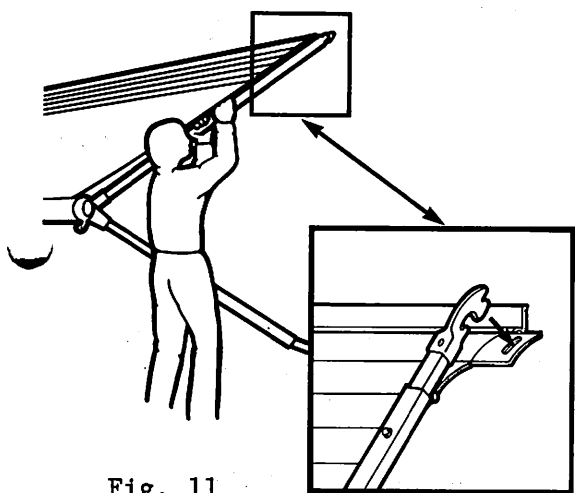

Fig. 11

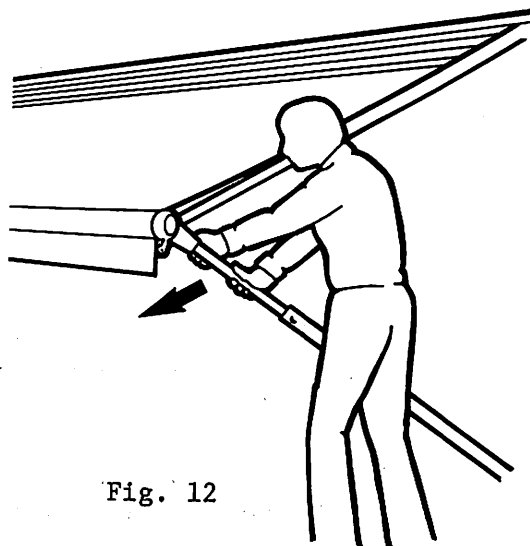

Fig. 12

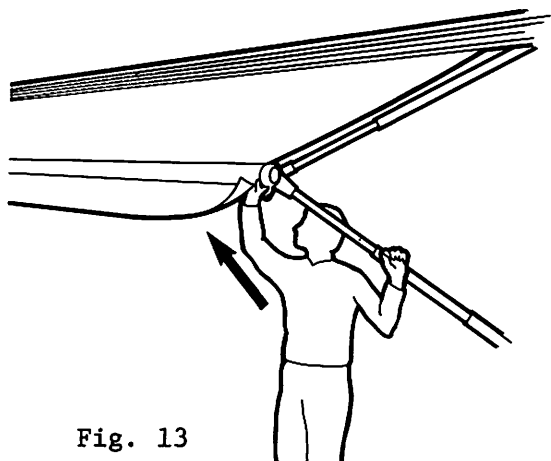

Fig. 13

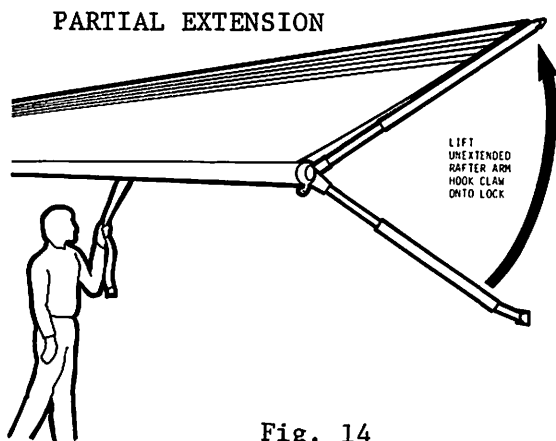

Fig. 14

## IF AWNING ROLLS UP UNEVEN

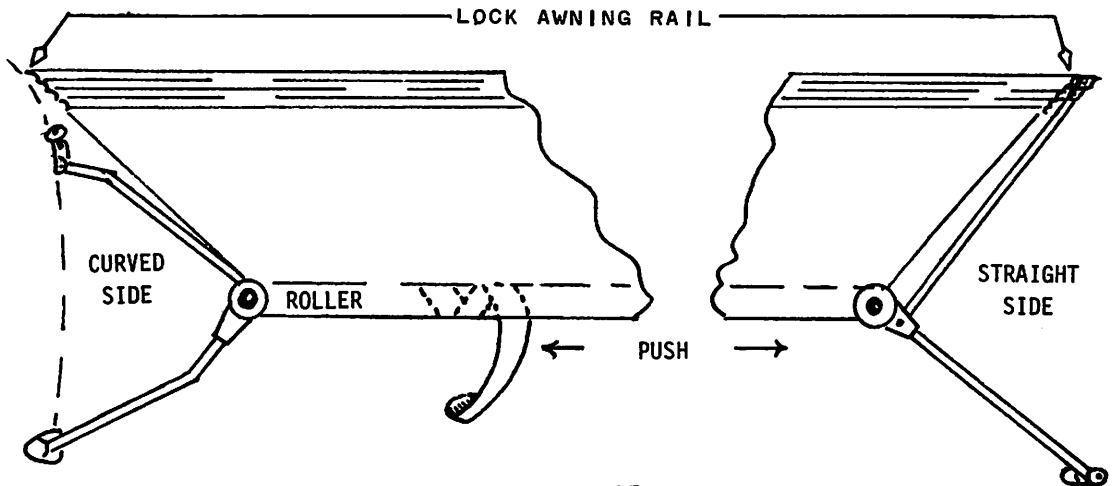

Fig. 15

Observe if the roll-up is even and in line with clamps. If not, then unroll and give roller a slight push toward the direction it should go. If you wish to have the awning roll up more in either direction, then spiral the pull tab in that direction.

**NOTE:** The tab must be spiraled around the roller as shown in (Fig. 15). This prevents a loose roll and bunching up of fabric.

# ***PARTS' LIST***

Zip Dee awnings and accessories are covered by one or more of the following patents;

#4,067,654	#4,634,172	#4,602,890	#4,576,192
#4,195,877	#4,262,955	#4,345,793	

# CUSTOM CONTOUR PATIO AWNING HARDWARE

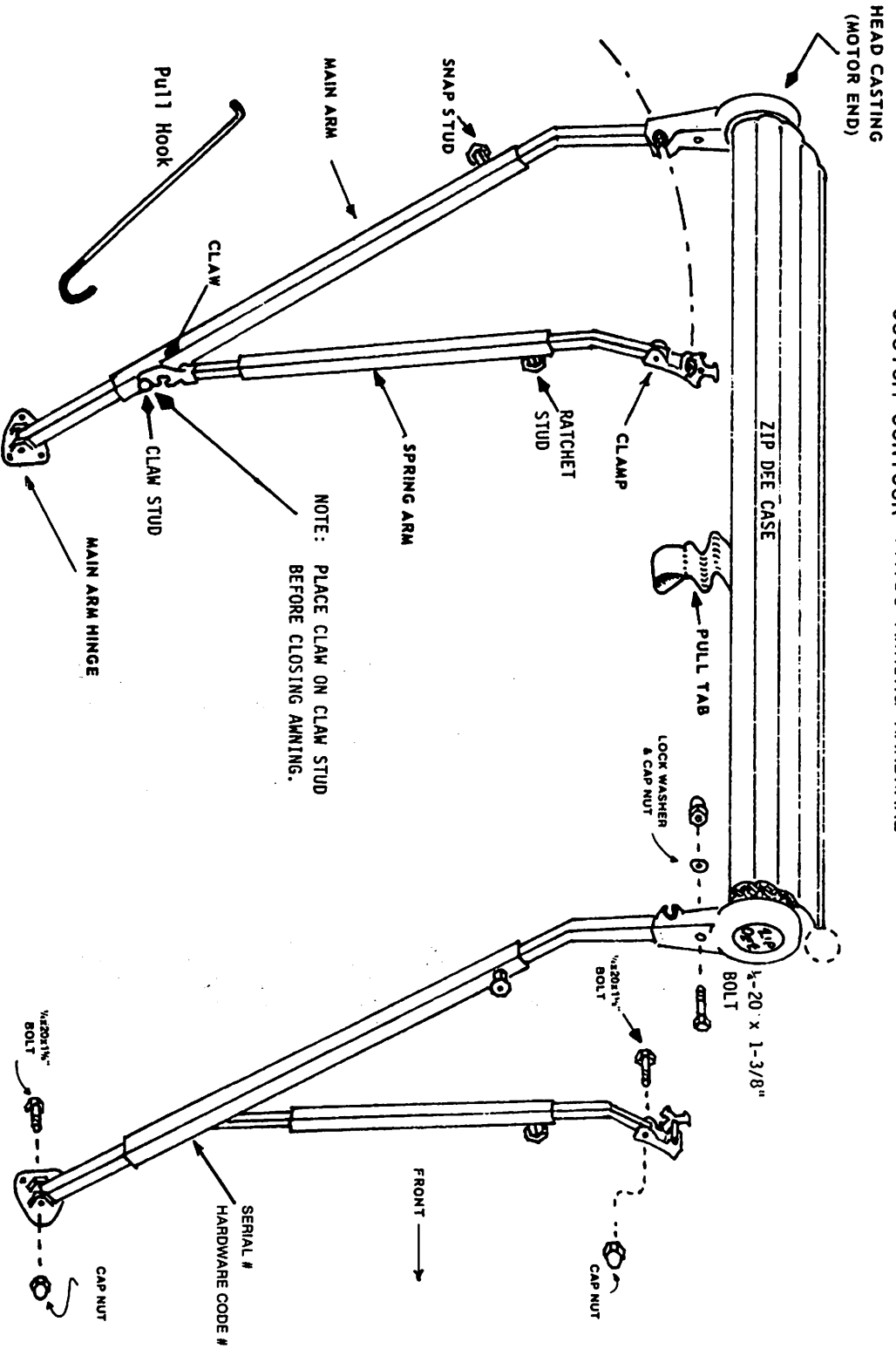

# UNIVERSAL STRAIGHTSIDE PATIO AWNING HARDWARE

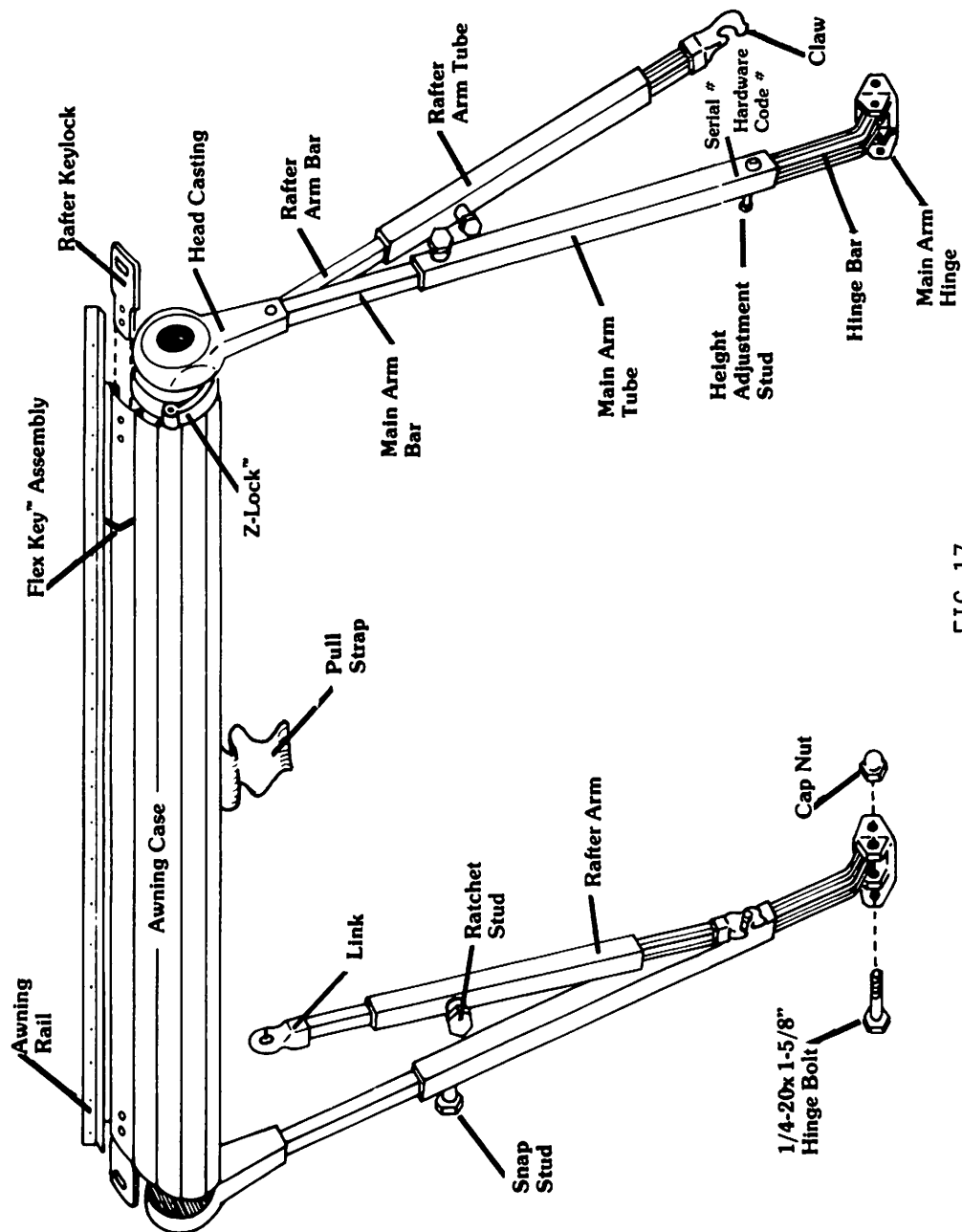
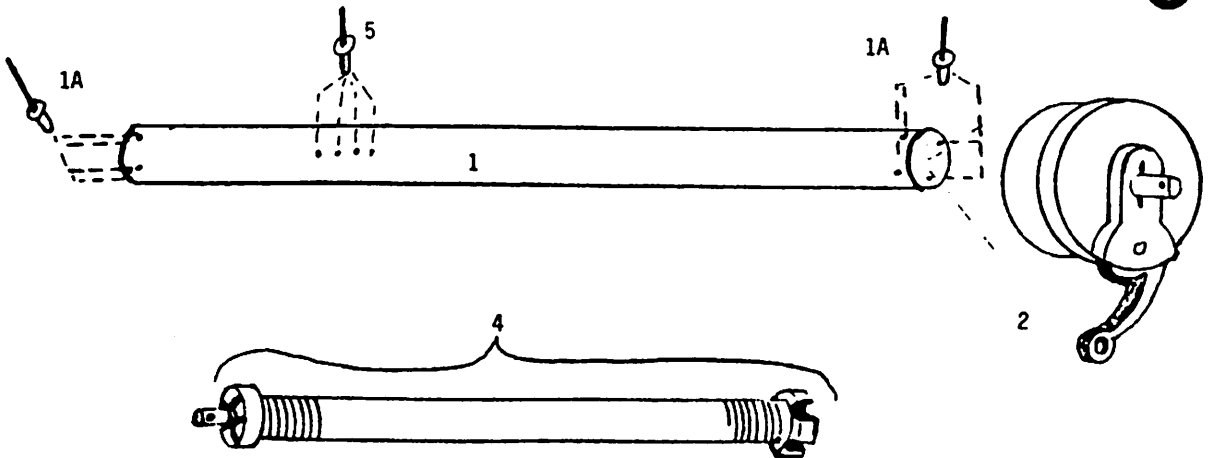

FIG 17



# Parts List



## PATIO AWNING ROLLER PARTS

I.D.#	PART NO.	DESCRIPTION
1	330000	3" 18ga. GAL. STEEL TUBE, PER FT.
1A	316160	ROLLER END CAP RIVETS
2	261130	Z LOCK ASSY
4	201100	P.A. SPRING ASSEMBLY
5	316100	SPRING STOP RIVET
NOT SHOWN	201101	Z SPRING ASSEMBLY

## ROLLER ASSEMBLY

(Includes Standard Spring and Z Lock)

200120	UP TO 12 FEET
200130	UP TO 13 FEET
200140	UP TO 14 FEET
200150	UP TO 15 FEET
200160	UP TO 16 FEET
200170	UP TO 17 FEET
200180	UP TO 18 FEET
200190	UP TO 19 FEET
200200	UP TO 20 FEET
200210	UP TO 21 FEET
200220	UP TO 22 FEET
200230	UP TO 23 FEET

1/89

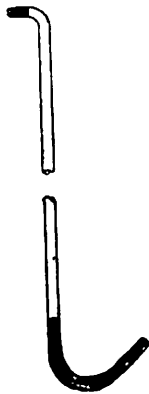

6

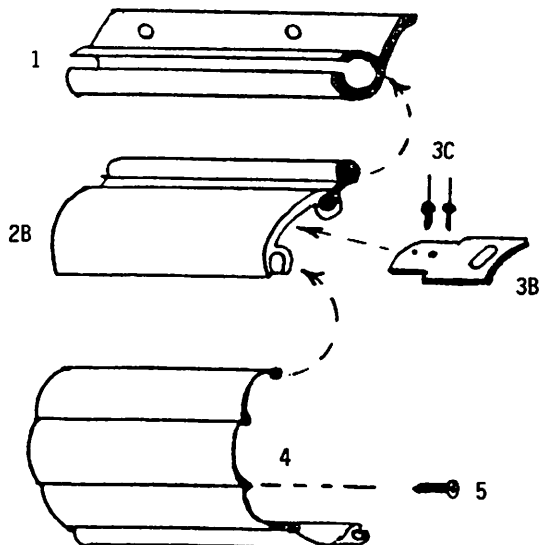

I.D.#	PART NO.	DESCRIPTION
1	343000	AWNING RAIL (PER FOOT)
2B	207200	FLEX KEY ASSEMBLY (PER FT.)
3B	325259	UNIVERSAL KEY LOCK
3C	316240	KEY LOCK RIVET
4	340000	SINGLE CASE SLAT
5	317010	CASE SCREW
6a	299111	PULL ROD, 36"
6b	299112	PULL ROD, 55"
	203100	COMPLETE CASE (Order exact length. Patio Awning requires 5 sections: 4 case slats and 1 Flex Key assembly)
		PATIO AWNING FABRIC ASSEMBLY*
		(Includes Fabric Rivets)
	206000	FINISHED CANOPY, PER FT.
	206120	UP TO 12 FEET
	206130	UP TO 13 FEET
	206140	UP TO 14 FEET
	206150	UP TO 15 FEET
	206160	UP TO 16 FEET
	206170	UP TO 17 FEET
	206180	UP TO 18 FEET
	206190	UP TO 19 FEET
	206200	UP TO 20 FEET
	206210	UP TO 21 FEET
	206220	UP TO 22 FEET
	206230	UP TO 23 FEET
	316130	FABRIC RIVETS
	206900	REPLACEMENT PULL STRAP ASSY.
	321280	POLYFOAM CORDING

# Contour Hardware

# Universal Hardware

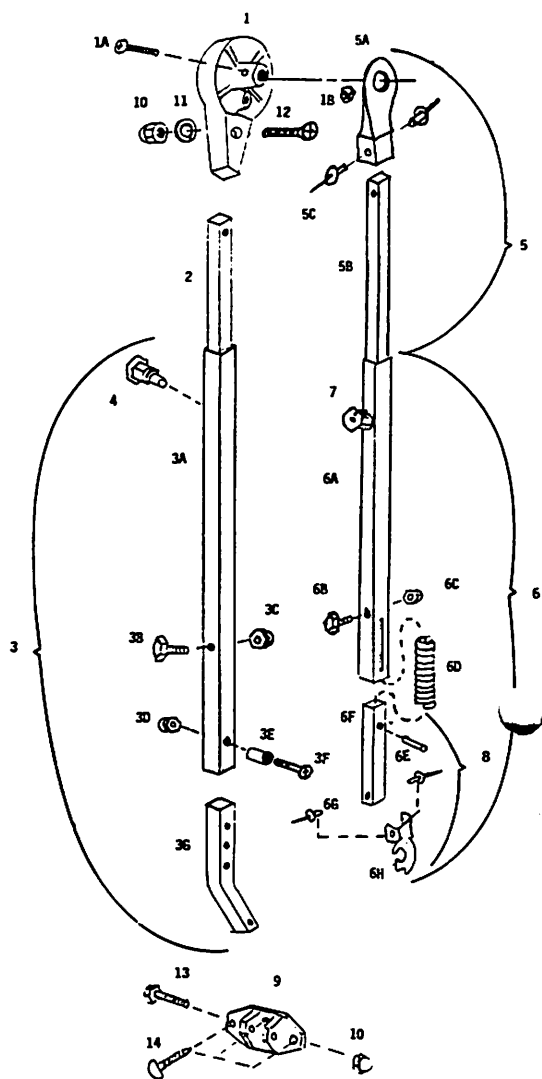
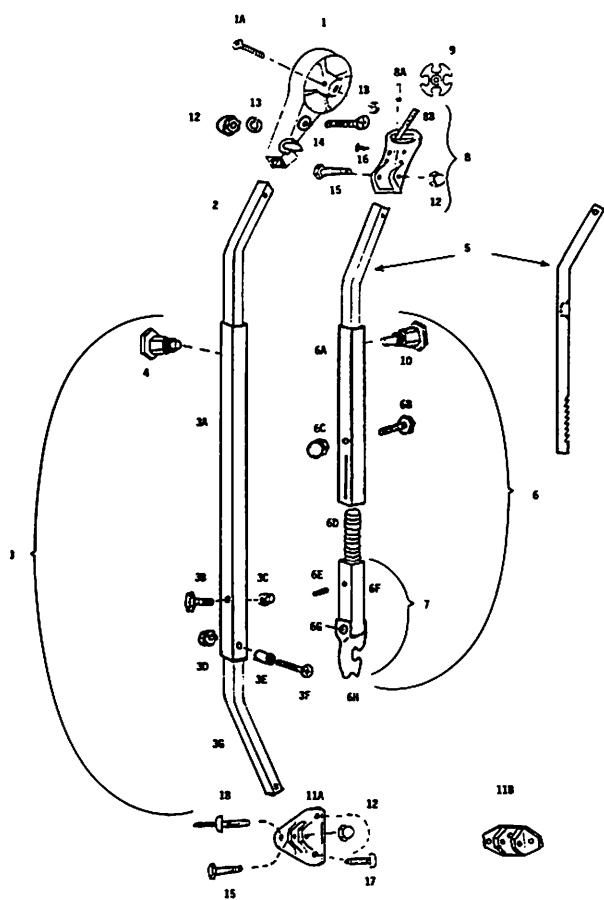

# CONTOUR PATIO AWNING HARDWARE

# UNIVERSAL PATIO AWNING HARDWARE

I.D.#	PART NO.	'89 CONTOUR HARDWARE
1	21000F-XXX	FRONT HEAD ASSY INCL:
1	21000R-XXX	REAR HEAD ASSY INCL:
1A	317080	10/32 x 1 1/2" MACHINE SCREW
1B	311070	10/32 NYLOCK HEX NUT
2	21300F-XXX	FRONT MAIN ARM BAR
2	21300R-XXX	REAR MAIN ARM BAR
3	21110F-XXX	FRT. MAIN ARM TUBE ASSY C/O
3	21110R-XXX	REAR MAIN ARM TUBE ASSY C/O
3A	211100-XXX	MAIN ARM TUBE
3B	310040	1/4-20 X 1 1/4" BOLT
3C	311020	1/4-20 ALUM CAP NUT
3D	311060	1/4-20 NYLOCK NUT
3E	325212	SPACER
3F	317081	1/4-20 X 2 1/8" STUD PIN
3G	211400-XXX	HINGE BAR
4	290002	SNAP STUD ASSEMBLY
5	214100-XXX	RAFTER ARM BAR
6	212200-XXX	RAFTER ARM TUBE ASSY C/O:
6A	212100-XXX	RAFTER ARM TUBE
6B	310030	1/4-20 X 1 3/8" BOLT
6C	311020	1/4-20 ALUM CAP NUT
6D	322100	COMPRESSION SPRING, LONG
6D	322110	COMPRESSION SPRING, SHORT
6E	313130	1/8 X 11/16 GUIDE PIN
6F	218600-XXX	STUB BAR, 5 1/4"/6"
6G	316220	3/16 BLIND RIVET
6H	320380	UNIVERSAL RAFTER CLAW
10	290001	RATCHET STUD
7	218610-XXX	CLAW BAR ASSEMBLY
11A	320059	BASE HINGE, RIB MOUNT
11B	320069	BASE HINGE, FLOOR MOUNT
8	21030F-XXX	ANY CLAMP ASSY., FRONT
8	21030R-XXX	ANY CLAMP ASSY., REAR
8	210121	FRONT CURVED CLAMP ASSY C/O
8	210122	REAR CURVED CLAMP ASSY C/O
8B	325110	3/8-16 THREADED STUD
8A	313040	1 X 1/8 DRIVE PIN
9	320219	CLAMP WHEEL
	299010-XXX	HARDWARE MOUNTING KIT C/O:
12	311010	(6) 1/4-20 CAP NUT
13	312010	(2) 1/4" LOCKWASHER
14	317190	(2) 1 3/8" FLAT HEAD BOLT
15	310010	(4) 1 5/8" BOLT
16	317030	(6) 10x3/4" SHEET METAL SCREW
17	317050	(4) 14x1" SHEET METAL SCREW
18	316030	(2) 3/16 X 1" EXPANDING RIVET
NOT SHOWN	317010	(2) 6 X 1/2" AWNING RAIL SCREW

1HD10F-XXX HALF SET OF HARDWARE -FRONT  
 1HD10R-XXX HALF SET OF HARDWARE - REAR  
 (CONSISTING OF ITEMS 1 THRU 18)

I.D.#	PART NO.	'89 UNIVERSAL HARDWARE
1	215000	HEAD CASTING ASSY, INCL:
1A	317080	10-32 X 1 1/2" MACHINE SCREW
1B	311070	10-32 NYLOCK HEX NUT
2	21900F-XXX	UNIVERSAL MAIN ARM BAR FRONT
2	21900R-XXX	UNIVERSAL MAIN ARM BAR REAR
3	21620F-XXX	FRONT MAIN ARM TUBE ASSY.
3	21620R-XXX	REAR MAIN ARM TUBE ASSY. C/O:
3A	216200	MAIN ARM TUBE ONLY
3B	310040	1/4-20 X 1 1/4" BOLT
3C	311020	1/4-20 CAP NUT, ALUM.
3D	311060	1/4-20 NYLOCK NUT
3E	325212	SPACER, 1/4 I.D.
3F	317081	1/4-20 X 2 1/8" MSC
3G	216700-XXX	HINGE BAR
4	290002	SNAP STUD ASSEMBLY
5	21710F-XXX	RAFTER ARM BAR ASSY., FRONT
5	21710R-XXX	RAFTER ARM BAR ASSY., REAR C/O:
5A	320360	RAFTER LINK CASTING
5B	217109-XXX	RAFTER ARM BAR
5C	316220	3/16 BLIND RIVET
6	218210	RAFTER ARM TUBE ASSY, C/O:
6A	218200	RAFTER ARM TUBE
6B	310030	1/4-20 X 1 3/8 BOLT
6C	311020	1/4-20 ALUM CAP NUT
6D	322110	COMPRESSION SPRING
6E	313130	1/8" X 11/16 GUIDE PIN
6F	218601	CLAW BAR
6G	316220	3/16 BLIND RIVET
6H	320380	UNIVERSAL RAFTER CLAW
7	290001	RATCHET STUD ASSY
8	218611	CLAW AND BAR ASSEMBLY WITH PIN
9	320069	FLOOR MOUNT BASE HINGE
	299510-XXX	HARDWARE MOUNTING KIT C/O:
10	311010	(2) 1/4-20 CAP NUT
11	312010	(2) 1/4" LOCK WASHER
12	317190	(2) 1 3/8" FLAT HEAD BOLT
13	310010	(2) 1 5/8" BOLT
14	317040	(6) 14X2" SHEET METAL SCREW
FOR	317010	(2) 6X1/2" AWNING RAIL SCREW
ROLLER	316240	(4) 1/8"x1/8" KEY LOCK RIVET
ASSY	325259	(2) KEY LOCK
1HD20F-XXX		HALF SET OF HARDWARE-FRONT
1HD20R-XXX		HALF SET OF HARDWARE-REAR (CONSISTING OF ITEMS 1 THRU 14)

(XXX) =INSERT HARDWARE CODE US1,US2,UC1,ETC.  
 FROM HARDWARE LABEL ON MAIN ARM

0989

XXX =INSERT HARDWARE CODE FROM  
 HARDWARE LABEL ON MAIN ARM

# HARDWARE --- WINDOW AWNINGS

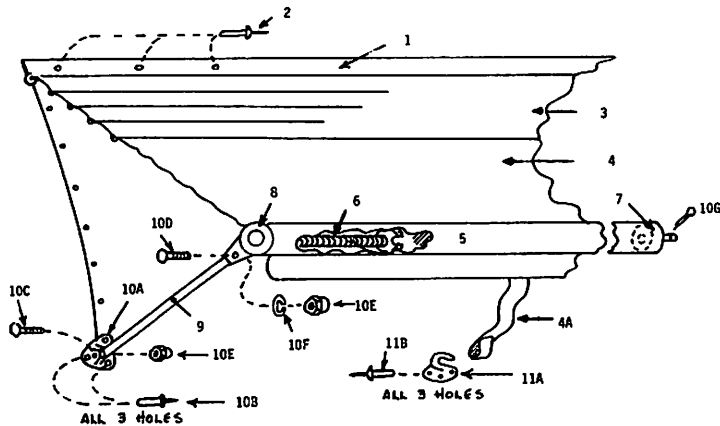

WINDOW AWNING PARTS LIST

I.D. NO.	PART NO	DESCRIPTION
1	342000	WINDOW AWNING RAIL
2	316150	5/32 BLIND RIVETS
3	340000	CASE SLATS (PER SLAT FT.)
4	226000(*)	WINDOW AWNING FABRIC (FT)
4A	226900(*)	REPLACEMENT PULL TAB W/RIVETS
5		ROLLER TUBE ONLY
5A	332000	2 1/4" TUBE (3' TO 5'6") (PER FT)
5B	331000	2 1/2" TUBE (6' TO 22') (PER FT)
6		WINDOW AWN. SPRING ASSY.
6A	221100	FOR 2 1/4" TUBE (ROUND WIRE)
6B	221200	FOR 2 1/2" TUBE (SQUARE WIRE)
7		IDLE END ASSEMBLY
7A	222100	2 1/4" IDLE END ASSY
7B	222200	2 1/2" IDLE END ASSY
8	320109	HEAD CASTING
9		SUPPORT ARM
9A	231100	FOR "047" ONLY (24 3/4")
9B	231200	FOR STD. AWNING (21 3/4")
9C	231300(#)	SPECIAL ARM (SPECIFY)
10	299310	INSTALLATION KIT, "047" WA ONLY
	299320	INSTALLATION KIT, STD. WA. C/O
10A	320069	("047") RECTANGULAR HINGE (QTY. 2)
10A	320059	(STD) TRIANGULAR HINGE (QTY. 2)
10B	316030	3/16" X 1 SPLIT RIVET (QTY. 6)
10C	310010	1/4-20 X 1 5/8" BOLT (QTY. 2)
10D	310040	1/4-20 X 1 1/4" BOLT (QTY. 2)
10E	311010	1/4-20 CAP NUT (QTY. 4)
10F	312010	1/4" LOCK WASHER (QTY. 2)
10G	313020	1/8 X 1" COTTER PIN (QTY. 2)
11	299330	HOLD DOWN HOOK KIT C/O:
11A	320119	HOOK CASTING
11B	316010	3/16X 3/4" RIVETS (QTY. 3)
	299340	TRAVEL LATCH KIT (NOT PICTURED)
		COMPLETE SET OF HARDWARE, C/O
		ITEMS 9(2),10(2),11(1) & 12(1)
	230100	FOR "047" AWNING ONLY
	230200	FOR STANDARD WINDOW AWNING
	230300(#)	FOR SPECIAL WINDOW AWNING

(\*) SPECIFY COLOR AND SLOPE

(#) SPECIFY SIZE



